

Options for bolt up brick faced steel backed units to be fixed to underside of masonry support units (supplied by others).

Header course 65mm high on face, 215mm faced soffit

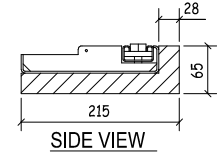

PLEASE NOTE BRICK SLIP IS 25MM, WITH 3MM ALLOWANCE FOR BONDING.

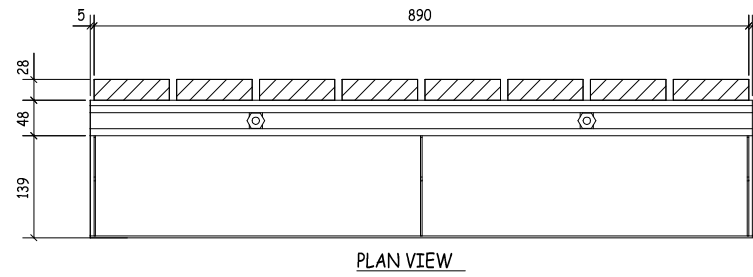

PLAN VIEW

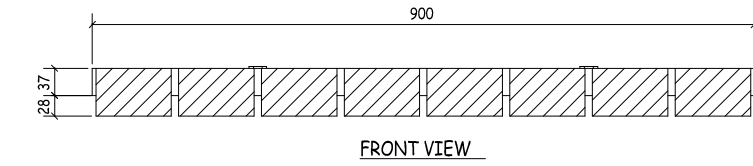

FRONT VIEW

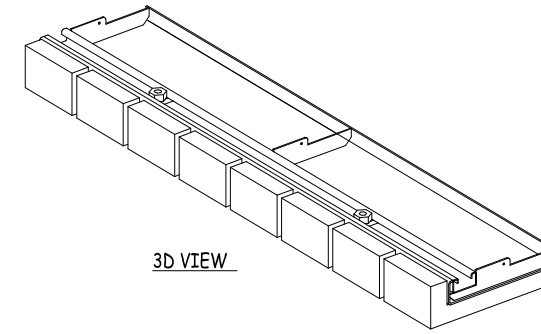

3D VIEW

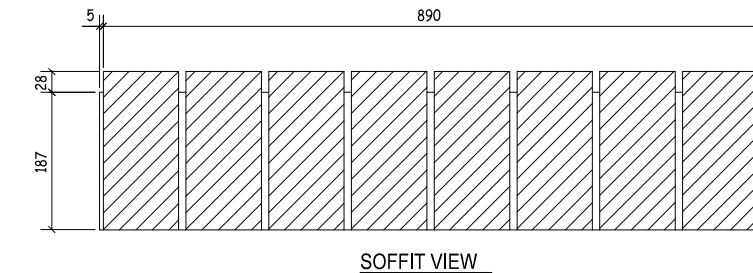

SOFFIT VIEW

DISCLAIMER: FAB-STEEL LIMITED ACCEPTS NO LIABILITY WITH RESPECT TO DRAWING ACCURACY OR QUANTITIES SHOWN. ALL DRAWINGS SHOULD BE APPROVED BY THE PROJECT PROFESSIONALS BEFORE PLACING ANY ORDER. CONTENTS OF THIS DRAWING REMAINS THE PROPERTY OF FAB-STEEL LIMITED AND NO REPRODUCTION WITHOUT WRITTEN PERMISSION IS ALLOWED.

NOTES

1. DO NOT SCALE FROM THIS DRAWING

NOTE

Typical masonry support slot sizes and spacing for bolt up brick faced units

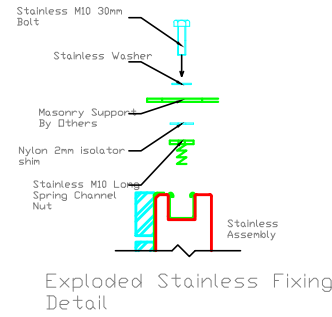

Exploded Stainless Fixing Detail

Soldier course 215mm high on face, 102mm faced soffit

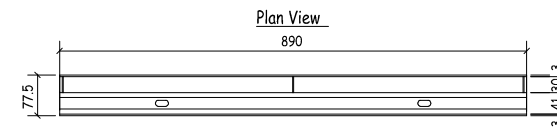

Plan View

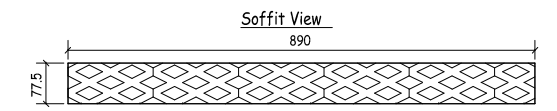

Soffit View

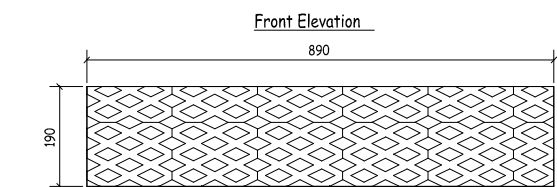

Front Elevation

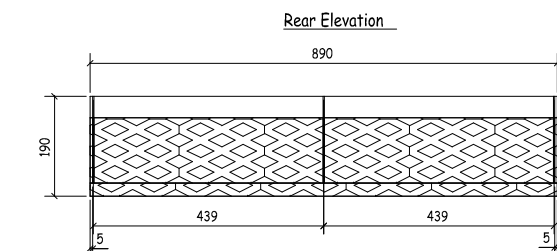

Rear Elevation

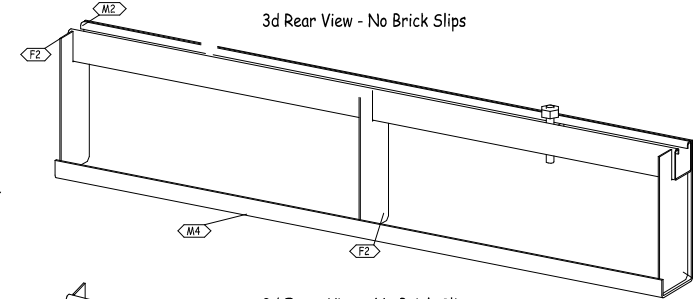

3d Rear View - No Brick Slips

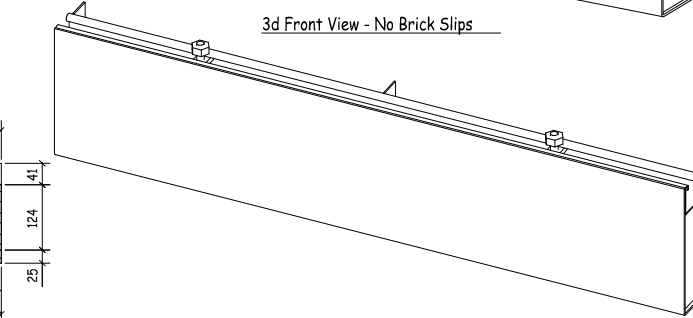

3d Front View - No Brick Slips

Section A-A - No Brick Slips

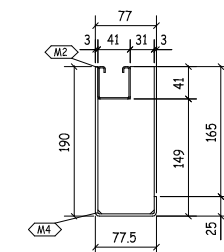

Section A-A - With Brick Slips

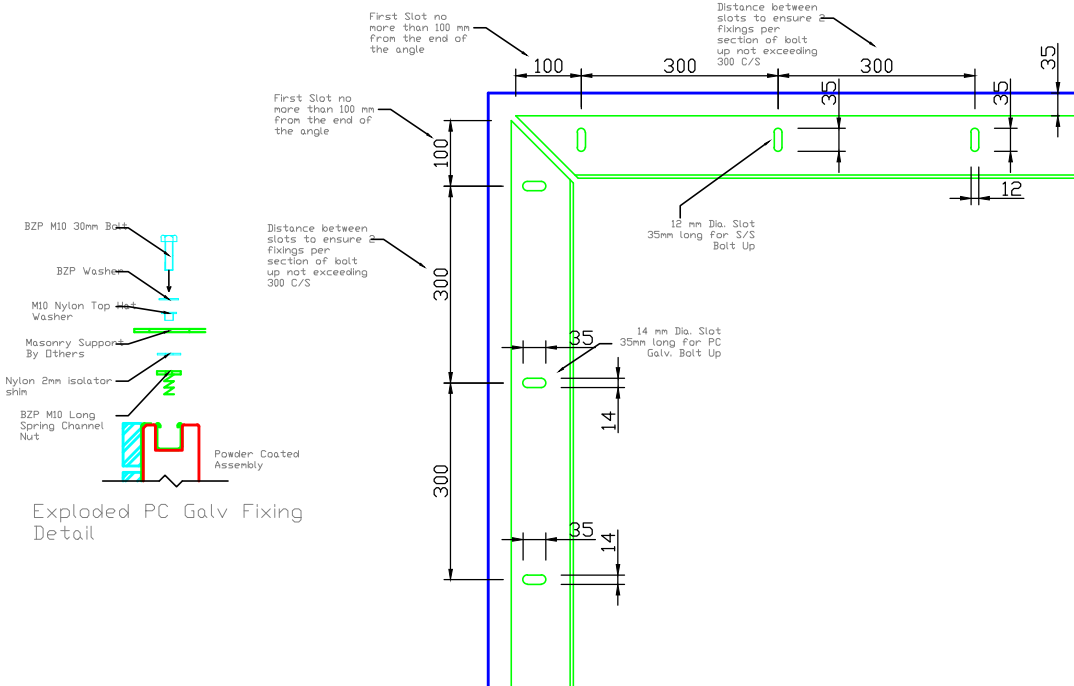
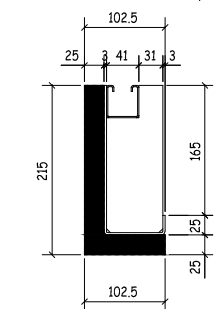

Other bond patterns, face and soffit dimensions available on request.

REV	REV DATE	PURPOSE OF REVISION
 <a href="http://www.fab-steel.co.uk">www.fab-steel.co.uk</a>		
Client .....		
Project .....		
Drawing Title <b>Pro-steel bolt up units</b>		
Status <b>FOR APPROVAL</b>		
Scale	As Noted at A3	DO NOT SCALE
Date	10.11.17	
Dwg NO	6367.1001	Rev -
This drawing is not to be used in whole or part other than for the intended purpose and project as defined on this drawing.		